

DPS TO TSW24VEC CONVERSIONS

DPS PART NUMBER	SUGGESTED REPLACEMENT
DPS-2402	TSW24VEC

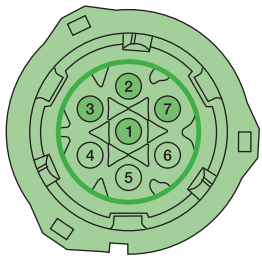
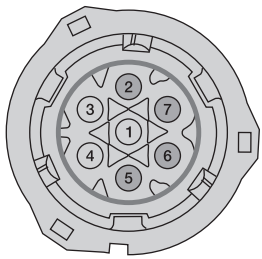

	TSW24VEC SWITCH	DPS PLUGS	
Not Used	PIN 1		
Battery B+ Output Supply	PIN 2	C1 PIN 7	Roll Over Battery B+ Output Supply
SW1 Aux N/O	PIN 3		
SW1 Aux N/O	PIN 4		
SW2 Field Isolation N/O	PIN 5	C1 PIN 5	Field Isolation N/O
SW2 Field Isolation N/O	PIN 6	C1 PIN 6	Field Isolation N/O
Battery B+ Output Supply	PIN 7	C2 PIN 3	Roll Over B+ Output Supply
E-Stop Negative B- Input Trigger	PIN 1	C2 PIN 2	Roll Over & E Stop Negative B- Input Trigger
Remote Switch Negative B- Output	PIN 2	C2 PIN 1	Roll Over & E Stop Negative B- Output Supply
Remote Switch Coil B- Input Trigger	PIN 3	C1 PIN 3	Remote Switch Disable B- Input Trigger (Neg Only)
Remote Switch Disable B- Input Trigger	PIN 4		
Not Used	PIN 5		
Not Used	PIN 6		
Remote Switch Enable B- Input Trigger	PIN 7	C1 PIN 4	Remote Switch Disable B- Input Trigger (Neg Only)

! TSW24VEC **does not** have an optional delayed negative output [DPS C1-1]

TSW24VEC only has a negative out to control both the Roll Over switch and Emergency stop. This needs to be taken in consideration on any vehicle using C1-7 to control and external equipment or modules.

TSW24VEC **does not** have Voltage Monitoring capability [DPS C2-7]

EXAMPLE BASIC WIRING DIAGRAM

- TSW24VEC

The TSWITCH® must always be mounted in a location where the manual control handle can be accessed with no obstructions. It is also recommended that it be mounted near the battery location or within view of the battery box. Never install inside the same compartment of the batteries. **The TSWITCH® is an electric device. Ensure it is NOT installed in areas that are prone to direct wheel splash i.e. area with excessive water ingress from moving vehicles (such as low to the ground, between wheels etc.)** Never install TSWITCH® near the exhaust converter or inside of the engine compartment. The TSWITCH® should always be mounted sitting upright or in a horizontal direction with DIN connectors facing down. See below illustrations

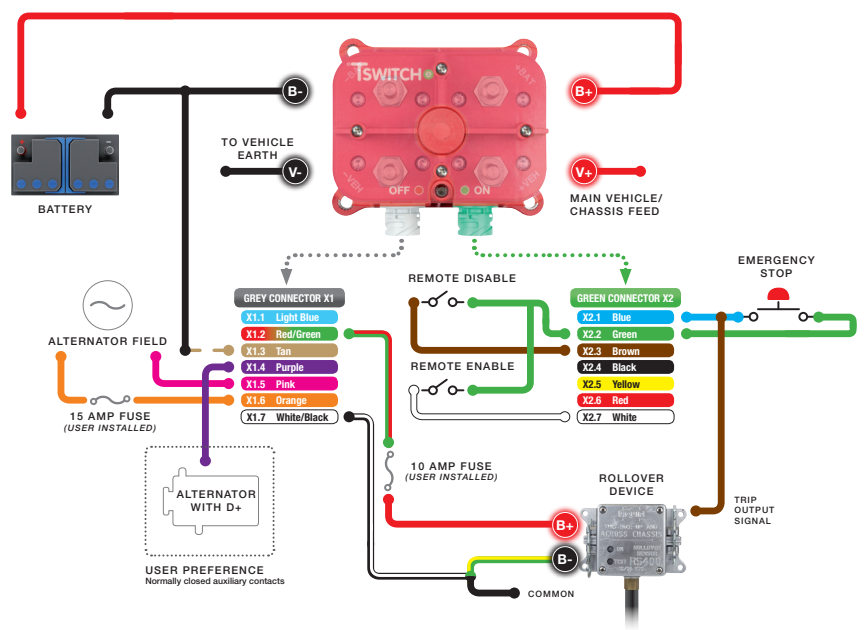
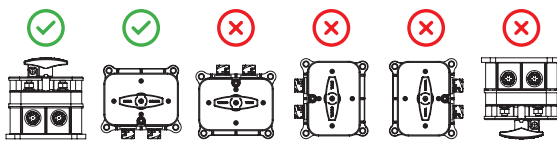

These instructions are meant as general guide only. All final wiring configurations are the responsibility installer. All installations to be carried out by a qualified technician.